

2 Bed for Rent at Olympia City

Address: , , Phnom Penh

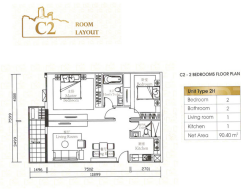

FACE AND FEATURES

Type	Floor	Bed	Bath	Total Area	Year Build
Condo	20	2	2	90.4m ²	2012

For Rent > \$1,500/mth

DESCRIPTION

Olympia City is in the heart of Phnom Penh, the capital of Kingdom of Cambodia, and is the new symbol of growth, development, and modernness, build on 11 acres (44,150 sqm) plot of land. Olympia city will include Residential, commercial, office buildings, serviced residences, hotel Olympia Plaza and Olympia Tower. Located in the heart of Phnom Penh, adjacent to major streets such as Monireth Boulevard, with easy and convenient walking distance to the central business district and widespread shopping destinations. Everything is within your reach, including hospitals, healthcare, clinics, universities, banks, shopping center, schools, and kindergarten C2 The River Condominium is mix development from the ground floor to the fifth floor is a shop-house, from the 7 floor is residential. The RIVER consists of 1987 sqm of land and has a total unit of 372. The interior design is luxurious and offers functionality and spaciousness through the simplicity of the layout. As a resident, you'll get pleasure from exclusive access to the swimming pool, a well-equipped gymnasium, and a BBQ and recreation space. Unit Detail Unit Type: 2H Floor: 14 Private area: 90.40sqm Bed: 2 Bath: 2 Furniture: Full furnished

CONTACT AGENT



CENTURY21 MEKONG

CEO

H/P: +85595955777

Email: chrek.soknim@c21mekong.com.kh